

## STANDARD KNIFE PROGRAMME

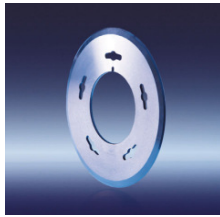

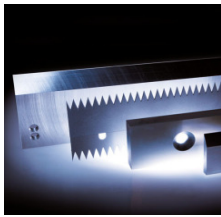
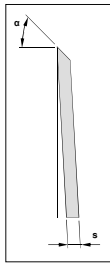

normal bevel (NF)

dished knife			material					surface		
dimensions ØD x Ød x s	item no. 224B070 xxx xxx	cutting angle α	chrome alloyed tool steel	high chrome alloyed tool steel	DPM	HSS	stainless	ground	polished	all polished
62 x 40 x 0,6	224B070005010	30°	X					X		
62 x 40 x 0,8	224B070005020	30°	X					X		
62 x 40 x 1,2	224B070005040	30°	X					X		
64 x 40 x 1,2	224B070053070	30°	X					X		
65 x 40 x 1,0	224B070053030	30°	X					X		
65 x 40 x 1,2	224B070053040	30°	X					X		

dished knife			material					surface		
dimensions ØD x Ød x s	item no. 224B080 xxx xxx	cutting angle α	chrome alloyed tool steel	high chrome alloyed tool steel	DPM	HSS	stainless	ground	polished	all polished
75 x 45 x 1,0	224B080003020	30°	X					X		
75 x 50 x 1,0	224B080026040	30°	X					X		

dished knife			material					surface		
dimensions ØD x Ød x s	item no. 224B090 xxx xxx	cutting angle α	chrome alloyed tool steel	high chrome alloyed tool steel	DPM	HSS	stainless	ground	polished	all polished
83 x 60 x 1,2	224B090263010	30°	X					X		
89 x 60 x 1,2	224B090010030	30°	X					X		
90 x 60 x 1,2	224B090012030	30°	X					X		
90 x 60 x 1,2	224B090382010	30°		X				X		

dished knife			material					surface		
dimensions ØD x Ød x s	item no. 224B100 xxx xxx	cutting angle α	chrome alloyed tool steel	high chrome alloyed tool steel	DPM	HSS	stainless	ground	polished	all polished
100 x 70 x 0,8	224B100027010	30°	X					X		
100 x 70 x 1,2	224B100027030	30°	X					X		
100 x 70 x 1,2	224B100379030	60°					X	X		

dished knife			material					surface		
dimensions ØD x Ød x s	item no. 224B110 xxx xxx	cutting angle α	chrome alloyed tool steel	high chrome alloyed tool steel	DPM	HSS	stainless	ground	polished	all polished
105 x 65 x 0,8	225B110001010	30°	X					X		
105 x 65 x 1,2	224B110102040	30°	X					X		
105 x 65 x 1,2	224B110001040	30°		X				X		
105 x 70 x 1,2	224B110038020	30°	X					X		
105 x 70 x 1,2	224B110383010	30°		X				X		
105 x 75 x 1,2	224B110068010	30°	X					X		
105,25 x 75 x 1,2	224B110381020	60°					X	X		
108 x 50 x 1,2	224B110407020	60°			X					X
110 x 50 x 1,2	224B110407010	60°			X					X

dished knife			material					surface		
dimensions ØD x Ød x s	item no. 224B130 xxx xxx	cutting angle α	chrome alloyed tool steel	high chrome alloyed tool steel	DPM	HSS	stainless	ground	polished	all polished
130 x 80 x 1,5	224B130 007 020	30°	X					X		
130 x 80 x 1,5	224B130 037 030	30°		X				X		
130 x 100 x 1,5	224B130 126 010	30°	X					X		
130 x 100 x 1,5	224B130 271 010	30°		X				X		
130 x 100 x 1,5	224B130 347 020	30°				X		X		

Other dimensions and materials on request.

# | DISHED KNIVES |

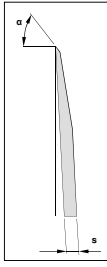

double bevel (SF)

dished knife			material				surface			
dimensions ØD x Ød x s	item no. 224C080 xxx xxx	cutting angle α	chrome alloyed tool steel	high chrome alloyed tool steel	DPM	HSS	stainless	ground	polished	all polished
75 x 40 x 0,6	224C080020010	30°	X					X		
75 x 45 x 1,0	224C080027030	30°	X					X		
75 x 50 x 1,0	224C080016020	30°	X					X		

dished knife			material				surface			
dimensions ØD x Ød x s	item no. 224C090 xxx xxx	cutting angle α	chrome alloyed tool steel	high chrome alloyed tool steel	DPM	HSS	stainless	ground	polished	all polished
90 x 60 x 1,2	224C090035010	30°	X					X		
90 x 60 x 1,2	224C090304010	30°		X				X		

dished knife			material				surface			
dimensions ØD x Ød x s	item no. 224C100 xxx xxx	cutting angle α	chrome alloyed tool steel	high chrome alloyed tool steel	DPM	HSS	stainless	ground	polished	all polished
100 x 70 x 0,8	224C100055020	30°	X					X		
100 x 70 x 1,2	224C100055010	30°	X					X		
100 x 70 x 1,2	224C100299020	15°	X					X		
100 x 70 x 1,2	224C100013010	30°		X				X		

dished knife			material				surface			
dimensions ØD x Ød x s	item no. 224C110 xxx xxx	cutting angle α	chrome alloyed tool steel	high chrome alloyed tool steel	DPM	HSS	stainless	ground	polished	all polished
105 x 65 x 1,2	224C110003030	30°	X					X		
105 x 65 x 1,2	224C110061030	30°		X				X		
105 x 70 x 1,2	224C110073010	30°	X					X		
105 x 70 x 1,2	224C110102010	30°		X				X		
105 x 75 x 0,8	224C110034030	30°	X					X		
105 x 75 x 1,2	224C110034010	30°	X					X		
105 x 75 x 1,2	224C110173010	30°		X				X		
105 x 75 x 1,2	224C110275010	30°			X			X		
110 x 70 x 1,2	224C110351010	38°	X					X		

dished knife			material				surface			
dimensions ØD x Ød x s	item no. 224C120 xxx xxx	cutting angle α	chrome alloyed tool steel	high chrome alloyed tool steel	DPM	HSS	stainless	ground	polished	all polished
120 x 75 x 1,2	224C120132010	30°	X					X		

Other dimensions and materials on request.

# | DISHED KNIVES |

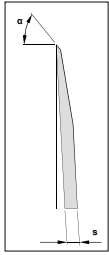

double bevel (SF)

dished knife			material					surface		
dimensions ØD x Ød x s	item no. 224C130 xxx xxx	cutting angle α	chrome alloyed tool steel	high chrome alloyed tool steel	DPM	HSS	stainless	ground	polished	all polished
130 x 80 x 1,5	224C130014010	30°	X					X		
130 x 80 x 1,5	224C130305020	30°	X							X
130 x 80 x 1,5	224C130157010	30°		X				X		
130 x 80 x 1,5	224C130320010	30°		X						X
130 x 80 x 1,5	224C130245010	30°			X					X
130 x 80 x 1,5	224C130245030	30°			X				X	
130 x 80 x 1,5	224C130245040	30°			X				X	
130 x 90 x 1,3	224C130207010	30°	X					X		
130 x 100 x 0,8	224C130067030	30°	X					X		
130 x 100 x 1,5	224C130067010	30°	X					X		
130 x 100 x 1,5	224C130174010	30°		X				X		
130 x 100 x 1,5	224C130291010	30°		X				X		
130 x 100 x 1,5	224C130288010	30°		X					X	

dished knife			material					surface		
dimensions ØD x Ød x s	item no. 224C140 xxx xxx	cutting angle α	chrome alloyed tool steel	high chrome alloyed tool steel	DPM	HSS	stainless	ground	polished	all polished
140 x 70 x 1,5	224C140246020	30°	X					X		
140 x 70 x 3,0	224C140082010	30°	X					X		
140 x 70 x 3,0	224C140001010	30°	X					X		
140 x 70 x 3,0	224C140075010	30°		X				X		
140 x 70 x 3,0	224C140075030	30°		X				X		
140 x 70 x 3,0	224C140216020	30°			X			X		
140 x 95 x 2,0	224C140191010	20°	X					X		

dished knife			material					surface		
dimensions ØD x Ød x s	item no. 224C150 xxx xxx	cutting angle α	chrome alloyed tool steel	high chrome alloyed tool steel	DPM	HSS	stainless	ground	polished	all polished
150 x 80 x 1,5	224C150326050	30°	X							X
150 x 80 x 2,0	224C150345030	30°		X				X		
150 x 80 x 2,5	224C150270010	25°	X					X		
150 x 80 x 2,5	224C150323010	25°		X				X		
150 x 80 x 2,5	224C150310010	25°		X				X		
150 x 80 x 2,5	224C150326010	30°		X						X
150 x 80 x 2,5	224C150326020	30°			X					X
150 x 80 x 2,5	224C150326060	60°			X					X
150 x 90 x 3,5	224C150026010	30°	X					X		
150 x 120 x 2,0	224C150093010	30°	X					X		

dished knife			material					surface		
dimensions ØD x Ød x s	item no. 224C170 xxx xxx	cutting angle α	chrome alloyed tool steel	high chrome alloyed tool steel	DPM	HSS	stainless	ground	polished	all polished
170 x 120 x 2,0	224C170361010	30°		X						X

Other dimensions and materials on request.

# | DISHED KNIVES |

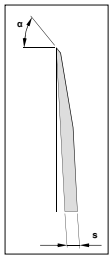

double bevel (SF)

dished knife			material					surface		
dimensions ØD x Ød x s	item no. 224C180 xxx xxx	cutting angle α	chrome alloyed tool steel	high chrome alloyed tool steel	DPM	HSS	stainless	ground	polished	all polished
180 x 90 x 3,5	224C180184010	30°	X					X		
180 x 140 x 2	224C180382010	30°	X					X		

dished knife			material					surface		
dimensions ØD x Ød x s	item no. 224C200 xxx xxx	cutting angle α	chrome alloyed tool steel	high chrome alloyed tool steel	DPM	HSS	stainless	ground	polished	all polished
200 x 80 x 4	224C200308010	25°	X					X		
200 x 80 x 4	224C200374020	25°		X					X	
200 x 80 x 4	224C200339010	25°			X			X		
200 x 120 x 3,5	224C200046010	30°	X					X		

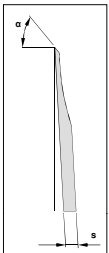

double hollow bevel (SHF)

dished knife			material					surface		
dimensions ØD x Ød x s	item no. 224D070 xxx xxx	cutting angle α	chrome alloyed tool steel	high chrome alloyed tool steel	DPM	HSS	stainless	ground	polished	all polished
62 x 40 x 0,6	224D070008010	30°	X					X		
62 x 40 x 1,2	224D070008020	30°	X					X		

dished knife			material					surface		
dimensions ØD x Ød x s	item no. 224D090 xxx xxx	cutting angle α	chrome alloyed tool steel	high chrome alloyed tool steel	DPM	HSS	stainless	ground	polished	all polished
90 x 55 x 1,0	224D0900075030	30°	X					X		
90 x 60 x 1,2	224D090005040	30°	X					X		

dished knife			material					surface		
dimensions ØD x Ød x s	item no. 224D100 xxx xxx	cutting angle α	chrome alloyed tool steel	high chrome alloyed tool steel	DPM	HSS	stainless	ground	polished	all polished
100 x 70 x 1,2	224D100017010	30°	X					X		
100 x 70 x 0,8	224D100135010	25°		X						X

dished knife			material					surface		
dimensions ØD x Ød x s	item no. 224D110 xxx xxx	cutting angle α	chrome alloyed tool steel	high chrome alloyed tool steel	DPM	HSS	stainless	ground	polished	all polished
105 x 65 x 1,2	224D110026030	30°	X					X		
105 x 75 x 0,8	224D110019030	30°	X					X		
105 x 75 x 1,0	224D110019020	30°		X				X		
105 x 75 x 1,2	224D110019010	30°	X					X		
105 x 75 x 1,2	224D110103010	30°		X				X		
105 x 75 x 1,2	224D110174010	30°		X					X	
108 x 75 x 1,2	224D110186010	30°	X					X		

Other dimensions and materials on request.

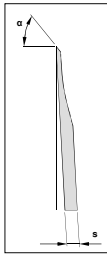

double hollow bevel (SHF)

dished knife			material					surface		
dimensions ØD x Ød x s	item no. 224D130 xxx xxx	cutting angle α	chrome alloyed tool steel	high chrome alloyed tool steel	DPM	HSS	stainless	ground	polished	all polished
130 x 80 x 1,5	224D130028010	30°	X						X	
130 x 80 x 1,5	224D130173010	30°	X							X
130 x 80 x 1,5	224D130160010	30°		X				X		
130 x 80 x 1,5	224D130177010	30°		X						X
130 x 100 x 1,5	224D130124010	30°		X				X		
130 x 100 x 1,5	224D130084020	30°		X						X
130 x 100 x 1,5	224D130050010	30°	X					X		

dished knife			material					surface		
dimensions ØD x Ød x s	item no. 224D150 xxx xxx	cutting angle α	chrome alloyed tool steel	high chrome alloyed tool steel	DPM	HSS	stainless	ground	polished	all polished
150 x 80 x 1,5	224D150189010	30°		X						X
150 x 80 x 2,5	224D150189020	30°		X						X

dished knife			material					surface		
dimensions ØD x Ød x s	item no. 224D170 xxx xxx	cutting angle α	chrome alloyed tool steel	high chrome alloyed tool steel	DPM	HSS	stainless	ground	polished	all polished
170 x 120 x 2,0	224D170118010	30°		X				X		

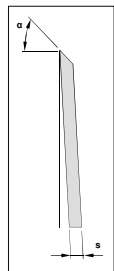

special bevel (SPF)

dished knife			material					surface		
dimensions ØD x Ød x s	item no. 224Bxxx xxx xxx	cutting angle α	chrome alloyed tool steel	high chrome alloyed tool steel	DPM	HSS	stainless	ground	polished	all polished
90 x 60 x 1,2	224B090382040	6°		X				X		
100 x 70 x 1,2	224B110428010	6°		X				X		
105 x 75 x 1,2	224B110068010	6°	X					X		
130 x 80 x 1,5	224B130037050	6°		X				X		
130 x 100 x 1,5	224B130271040	6°		X				X		

Other dimensions and materials on request.

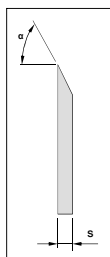

normal bevel (NF)

top knife			material						surface		
dimensions ØD x Ød x s	item no. 231G110 xxx xxx	cutting angle α	chrome alloyed tool steel	high chrome alloyed tool steel	DPM 23	DPM 10	HSS	stainless	ground	polished	all polished
105 x 75 x 1,5	231G110274010	30°		X							X

top knife			material						surface		
dimensions ØD x Ød x s	item no. 231G110 xxx xxx	cutting angle α	chrome alloyed tool steel	high chrome alloyed tool steel	DPM 23	DPM 10	HSS	stainless	ground	polished	all polished
130 x 80 x 5	231G130 358 010	5°			X						X

top knife			material						surface		
dimensions ØD x Ød x s	item no. 231G150 xxx xxx	cutting angle α	chrome alloyed tool steel	high chrome alloyed tool steel	DPM 23	DPM 10	HSS	stainless	ground	polished	all polished
150 x 120 x 1,6	231G150301010	60°						X	X		

top knife			material						surface		
dimensions ØD x Ød x s	item no. 231G180 xxx xxx	cutting angle α	chrome alloyed tool steel	high chrome alloyed tool steel	DPM 23	DPM 10	HSS	stainless	ground	polished	all polished
180 x 70 x 2,0	231G180159020	45°			X					X	

top knife			material						surface		
dimensions ØD x Ød x s	item no. 231G200 xxx xxx	cutting angle α	chrome alloyed tool steel	high chrome alloyed tool steel	DPM 23	DPM 10	HSS	stainless	ground	polished	all polished
200 x 65 x 2,0	231G200118020	45°	X						X		
200 x 65 x 2,0	231G200136020	45°		X					X		
200 x 65 x 2,0	231G200166010	45°			X				X		
200 x 65 x 2,0	231G200166020	45°				X			X		
200 x 65 x 2,5	231G200413030	30°				X				X	
200 x 65 x 2,5	231G200315020	45°			X					X	
200 x 65 x 3,0	231G200308010	60°		X					X		
200 x 70 x 2,6	231G200257010	45°			X				X		

top knife			material						surface		
dimensions ØD x Ød x s	item no. 231G220 xxx xxx	cutting angle α	chrome alloyed tool steel	high chrome alloyed tool steel	DPM 23	DPM 10	HSS	stainless	ground	polished	all polished
220 x 180 x 4,0	231G220300030	6°	X						X		

Other dimensions and materials on request.

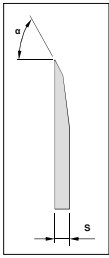

double bevel (SF)

top knife			material						surface		
dimensions ØD x Ød x s	item no. 231G090 xxx xxx	cutting angle α	chrome alloyed tool steel	high chrome alloyed tool steel	DPM 23	DPM 10	HSS	stainless	ground	polished	all polished
90 x 60 x 1,2	231G0900330010	30°	X							X	
90 x 60 x 1,2	231G0900330020	30°		X						X	

top knife			material						surface		
dimensions ØD x Ød x s	item no. 231G100 xxx xxx	cutting angle α	chrome alloyed tool steel	high chrome alloyed tool steel	DPM 23	DPM 10	HSS	stainless	ground	polished	all polished
94 x 55 x 5,0	231G100291010	60°			X				X		
94 x 55 x 5,0	231G100138010	60°					X		X		

top knife			material						surface		
dimensions ØD x Ød x s	item no. 231G110 xxx xxx	cutting angle α	chrome alloyed tool steel	high chrome alloyed tool steel	DPM 23	DPM 10	HSS	stainless	ground	polished	all polished
105 x 70 x 2,0	231G110316020	30°		X						X	
105 x 70 x 2,0	231G110316010	7°		X						X	
105 x 45 x 3,0	231G110079010	30°		X					X		
110 x 45 x 3,0	231G110411010	70°			X					X	

top knife			material						surface		
dimensions ØD x Ød x s	item no. 231G130 xxx xxx	cutting angle α	chrome alloyed tool steel	high chrome alloyed tool steel	DPM 23	DPM 10	HSS	stainless	ground	polished	all polished
130 x 100 x 2,0	231G130476010	30°			X					X	
130 x 100 x 3,0	231G130390010	25°	X						X		
130 x 100 x 3,0	231G130390020	25°		X			X		X		

top knife			material						surface		
dimensions ØD x Ød x s	item no. 231G150 xxx xxx	cutting angle α	chrome alloyed tool steel	high chrome alloyed tool steel	DPM 23	DPM 10	HSS	stainless	ground	polished	all polished
146 x 45 x 3,0	231G150416010	70°			X					X	
150 x 70 x 5,0	231G150193010	30°		X					X		

top knife			material						surface		
dimensions ØD x Ød x s	item no. 231G160 xxx xxx	cutting angle α	chrome alloyed tool steel	high chrome alloyed tool steel	DPM 23	DPM 10	HSS	stainless	ground	polished	all polished
154 x 45 x 3,0	231G160410010	70°			X					X	

top knife			material						surface		
dimensions ØD x Ød x s	item no. 231G180 xxx xxx	cutting angle α	chrome alloyed tool steel	high chrome alloyed tool steel	DPM 23	DPM 10	HSS	stainless	ground	polished	all polished
180 x 70 x 3,0	231G180090050	45°			X					X	
180 x 70 x 5,0	231G180100010	30°	X						X		
180 x 70 x 5,0	231G180247010	45°		X					X		

top knife			material						surface		
dimensions ØD x Ød x s	item no. 231G200 xxx xxx	cutting angle α	chrome alloyed tool steel	high chrome alloyed tool steel	DPM 23	DPM 10	HSS	stainless	ground	polished	all polished
198 x 80 x 5,0	231G200269030	60°			X					X	
200 x 65 x 2,5	231G200413010	30°			X					X	
200 x 70 x 5,0	231G200462010	45°			X					X	
200 x 90 x 3,0	231G200124030	60°			X					X	
200 x 90 x 3,0	231G200124060	60°			X					X	
200 x 90 x 5,0	231G200124050	60°			X					X	
200 x 90 x 5,0	231G200084010	60°	X						X		
200 x 90 x 5,0	231G200105010	60°		X					X		

top knife			material						surface		
dimensions ØD x Ød x s	item no. 231G220 xxx xxx	cutting angle α	chrome alloyed tool steel	high chrome alloyed tool steel	DPM 23	DPM 10	HSS	stainless	ground	polished	all polished
220 x 80 x 5,0	231G220061010	60°		X						X	
220 x 80 x 5,0	231G220192010	60°			X					X	

top knife			material						surface		
dimensions ØD x Ød x s	item no. 231G000 xxx xxx	cutting angle α	chrome alloyed tool steel	high chrome alloyed tool steel	DPM 23	DPM 10	HSS	stainless	ground	polished	all polished
220 x 90 x 3,0	231G000394010	60°			X					X	
250 x 90 x 5,0	231G000394020	60°			X					X	

Other dimensions and materials on request.



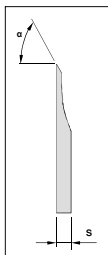

double hollow bevel (SHF)

top knife			material						surface		
dimensions ØD x Ød x s	item no. 231G150 xxx xxx	cutting angle α	chrome alloyed tool steel	high chrome alloyed tool steel	DPM 23	DPM 10	HSS	stainless	ground	polished	all polished
150 x 80 x 2,5	231G150359010	30°		X						X	
150 x 80 x 2,5	231G150381010	30°			X					X	
150 x 80 x 2,5	231G150359040	25°		X						X	
150 x 80 x 2,5	231G150137010	30°		X						X	

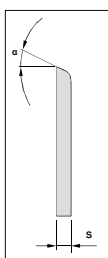

special bevel (SPF)

top knife			material						surface		
dimensions ØD x Ød x s	item no. 231G130 xxx xxx	cutting angle α	chrome alloyed tool steel	high chrome alloyed tool steel	DPM 23	DPM 10	HSS	stainless	ground	polished	all polished
130 x 80 x 5,0	231G130358010	5°			X						X

top knife			material						surface		
dimensions ØD x Ød x s	item no. 231G150 xxx xxx	cutting angle α	chrome alloyed tool steel	high chrome alloyed tool steel	DPM 23	DPM 10	HSS	stainless	ground	polished	all polished
150 x 80 x 2,5	231G150368010	6°		X						X	

Other dimensions and materials on request.

type NG

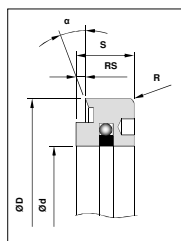

type NG-TCT

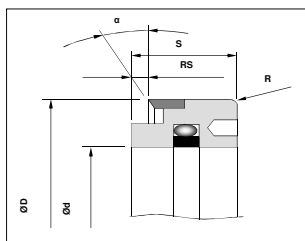

bottom knife					material					surface		
dimensions D x d x s	item no. 269A / 280A	type	RS	R	chrome alloyed tool steel	high chrome alloyed tool steel	DPM	TCT	HSS	stainless	ground	polished
46 x 25 x 10	269A004001001	NG	2,0	1,0	X						X	
50 x 25 x 10	269A047001001	NG	2,0	-	X						X	
60 x 30 x 10	269A002002001	NG	2,0	2,0	X						X	
77 x 45 x 10	269A001001001	NG	2,0	1,5	X						X	
77 x 45 x 15	269A006001001	NG	2,0	1,5	X						X	
90 x 60 x 15	269A008006001	NG	2,5	1,5	X						X	
105 x 60 x 15	269A003001001	NG	2,5	1,5	X						X	
105 x 60 x 20	269A038001001	NG	2,5	1,5		X					X	
105 x 80 x 10	269A133001001	NG	2,5	-	X						X	
105 x 80 x 15	269A005001001	NG	2,5	1,0	X						X	
105 x 80 x 15	280A040001001	NG-TCT	2,5	1,5				X			X	
105 x 80 x 20	269A005003001	NG	2,5	1,0	X						X	
105 x 80 x 24,5	280A128001001	NG-TCT	2,5	-				X			X	
125 x 100 x 18	269A024001001	NG	2,0	1,0	X						X	

type NN without groove

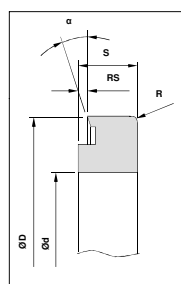

type NN-TCT without groove

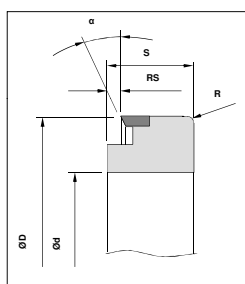

description					material					surface		
dimensions D x d x s	item no. 221B / 280A	type	RS	R	chrome alloyed tool steel	high chrome alloyed tool steel	DPM	TCT	HSS	stainless	ground	polished
60 x 40 x 5,0	221B060680010	NN	1,5	-		X					X	
60 x 40 x 10	221B060039050	NN	2,0	-	X						X	
77 x 45 x 10	221B080023010	NN	2,0	-	X						X	
77 x 60 x 5,0	221B080006010	NN	1,5	-	X						X	
77 x 60 x 10	221B080025010	NN	1,5	-	X						X	
77 x 60 x 10	221B080025020	NN	2,0	-	X						X	
80 x 60 x 5,0	221B080051260	NN	1,5	-	X						X	
80 x 60 x 5,0	221B080571030	NN	1,5	0,5	X						X	
80 x 60 x 10	221B080051060	NN	1,5	-	X						X	
80 x 60 x 10	221B080051010	NN	2,0	-	X						X	
80 x 60 x 10	221B080051030	NN	2,5	-	X						X	
82 x 60 x 10	221B090441010	NN	2,0	-	X						X	
90 x 60 x 10	221B090032020	NN	2,0	-	X						X	
105 x 80 x 10	221B110090030	NN	2,0	-	X						X	
105 x 90 x 5,0	221B110147010	NN	1,5	-	X						X	
105 x 90 x 5,0	221B110158010	NN	1,5	1,0	X						X	
105 x 90 x 10	221B110147020	NN	2,0	-	X						X	
105 x 90 x 10	221B110574020	NN	2,0	0,5	X						X	
105 x 90 x 10	280A015001001	NN-TCT	2,0	-				X				X
105 x 90 x 19	221B110709010	NN	2,0	-	X						X	
150 x 100 x 6,0	221B150592010	NN	-	-		X					X	
150 x 100 x 10	221B150300010	NN	1,5	-	X						X	
150 x 120 x 10	221B150157040	NN	2,0	-	X						X	
150 x 120 x 15	221B150157030	NN	2,0	-	X						X	

other dimensions and materials on request

type NN with groove

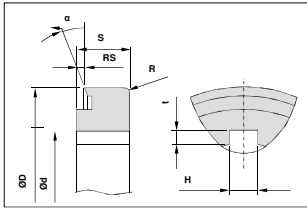

type NN-TCT with groove

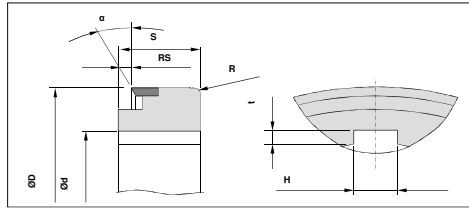

description					material					surface	dimensions		
dimensions D x d x s	item no. 220B	type	RS	R	chrome alloyed tool steel	high chrome alloyed tool steel	DPM	TCT	HSS	stainless	ground	H	t
77 x 55 x 05	220B080142010	NN	1,5	-		X					X	6,3	2,5
100 x 60 x 05	220B100147010	NN	2,0	0,5x45°	X						X	8,4	2,5

type NS with screw fixing

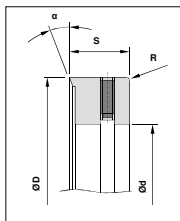

type NS-TCT with screw fixing

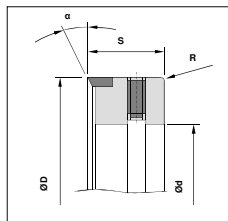

description					material					surface		
dimensions D x d x s	item no. 280A	type	RS	R	chrome alloyed tool steel	high chrome alloyed tool steel	DPM	TCT	HSS	stainless	ground	polished
160 x 130 x 25	280A115001001	NS-TCT	-	3,0				X				X

Other dimensions and materials on request.

type UN

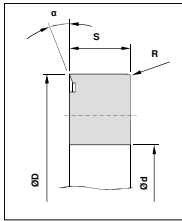

type UN-TCT

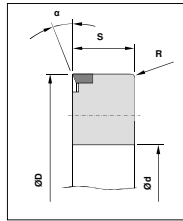

description		material								surface		
dimensions D x d x s	item no. 280A	type	RS	R	chrome alloyed tool steel	high chrome alloyed tool steel	DPM	TCT	HSS	stainless	ground	polished
132 x 55,05 x 4,5	231H140149010	UN				X					X	
160 x 100 x 17,5	231H160402020	UN			X						X	
200 x 144 x 17,5	231H200363040	UN			X						X	
200 x 144 x 17,5	231H200363010	UN				X					X	
200 x 163 x 12,0	231H200401020	UN			X						X	
250 x 188 x 10,0	280A095001001	UN-TCT						X			X	
250 x 188 x 25,0	280A109001001	UN-TCT	-	1,0				X				X
250 x 219 x 15,0	280A108001001	UN-TCT	-	2,0				X				X

type UN

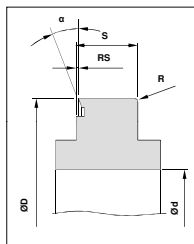

type UN-TCT

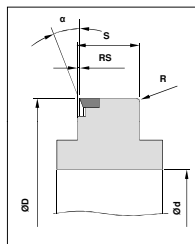

description		material								surface		
dimensions D x d x s	item no. 280A	type	RS	R	chrome alloyed tool steel	high chrome alloyed tool steel	DPM	TCT	HSS	stainless	ground	polished
202 x 155 x 20	280A001001001	UN-TCT	1,0	-				X				X

type UN

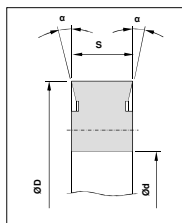

type UN-TCT

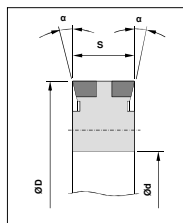

description		material								surface		
dimensions D x d x s	item no. 280A	type	RS	R	chrome alloyed tool steel	high chrome alloyed tool steel	DPM	TCT	HSS	stainless	ground	polished
200 x 150 x 10	280A100001001	UN-TCT						X				X
250 x 188 x 15	280A090001001	UN-TCT						X				X
250 x 188 x 25	280A006002001	UN-TCT						X				X
250 x 188 x 15	231H250341020	UN				X					X	
250 x 188 x 15	231H250192010	UN				X					X	
250 x 188 x 25	231H250192010	UN				X					X	

Other dimensions and materials on request.

Cup Knives

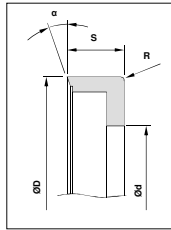

Cup Knives - TCT

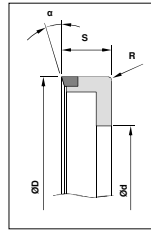

description		material							surface			
dimensions D x d x s	item no. 269A / 280A	type	RS	R	chrome alloyed tool steel	high chrome alloyed tool steel	DPM	TCT	HSS	stainless	ground	polished
88 x 55 x 12	226B090296020								X		X	
88 x 55 x 12	226B090411010						X				X	
105 x 85 x 10	226C110222020					X					X	
130 x 75 x 5,0	226B130036020				X						X	
132 x 70 x 4,0	226B140191010					X					X	
165 x 105 x 10	226B170417010			3,0					X		X	
88 x 55 x 10	280A112001001	HM	-	1,0				X				X
130 x 85 x 10	280A007001001	HM	-	-				X				X
160 x 112 x 10,5	280A117001001	HM	-	-				X				X
200 x 160 x 10	280A054001001	HM	-	-				X				X
240 x 188 x 30	280A008002001	HM	-	3,0				X				X

Other dimensions and materials on request.

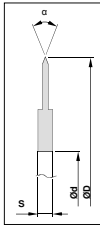

description			material				surface					
dimensions ØD x Ød x s	item no. 239B050 xxx xxx	cutting angle α	radius	cylinder	chrome alloyed tool steel	high chrome all. tool steel	DPM	HSS	stain- less	ground	polished	all polished
50 x 19 x 5,2	239B050003010	70°	0,15 - 0,2		X					X		
50 x 19 x 6,35	239B050003020	70°	0,15 - 0,2		X					X		
50 x 19 x 6,35	239B050098010	70°	0,15 - 0,2			X				X		
50 x 19 x 6,35	239B050179030	30°	0,05 0,1		X					X		

description			material				surface					
dimensions ØD x Ød x s	item no. 239B080 xxx xxx	angle α	edge type radius	cylinder	chrome alloyed tool steel	high chrome all. tool steel	DPM	HSS	stain- less	ground	polished	all polished
76,20 x 19 x 6,35	239B080318010	30°	0,15 - 0,2			X				X		
76,96 x 12 x 2,5	239B080151010	45°	0,1 - 0,15		X					X		
76,96 x 12 x 2,5	239B080371010	30°	sharply rolled-up							X		
76,96 x 19 x 3,149	239B080296040	30°	sharply rolled-up			X				X		
76,96 x 19 x 5,2	239B08000101B	60°	0,1 - 0,15		X					X		
76,96 x 19 x 5,2	239B08000101E	45°	0,1 - 0,15		X					X		
76,96 x 19 x 5,2	239B08000101D	30°	0,15-0,2		X					X		
76,96 x 19 x 5,2	239B080296020	30°	sharply rolled-up			X				X		
76,96 x 19 x 5,2	239B08012301E	45°	0,1 - 0,15			X				X		
76,96 x 19 x 5,2	239B08012301B	60°	0,1 - 0,15			X				X		
76,96 x 19 x 6,197	239B08034309C	40°	0,05 - 0,1			X				X		
76,96 x 19 x 6,35	239B08000102B	60°	0,1 - 0,15		X					X		
76,96 x 19 x 6,35	239B080381020	60°	sharply rolled-up		X					X		
76,96 x 19 x 6,35	239B08000102E	45°	0,1 - 0,15		X					X		
76,96 x 19 x 6,35	239B08000102D	30°	0,15 - 0,2		X					X		
76,96 x 19 x 6,35	239B08012302B	60°	0,1 - 0,15			X				X		
76,96 x 19 x 6,35	239B08012302E	45°	0,1 - 0,15			X				X		
76,96 x 19 x 6,35	239B08012302D	30°	0,15 - 0,2			X				X		
76,96 x 19 x 6,35	239B08012302P	14°	0,1 - 0,15			X				X		
76,96 x 22 x 6,197	239B080249010	45°	sharply ground		X					X		
76,96 x 22 x 6,197	239B080069060	30°	0,05		X					X		
76,96 x 22 x 6,197	239B080069010	45°	0,1 - 0,15		X					X		
76,96 x 22 x 6,15	239B080325020	70°	sharply rolled-up			X				X		
76,96 x 22 x 6,15	239B080325010	30°	sharply rolled-up			X				X		
80,00 x 40 x 1,0	239B080430010	40°		0,3						X		

description			material				surface					
dimensions ØD x Ød x s	item no. 239B100 xxx xxx	cutting angle α	radius	cylinder	chrome alloyed tool steel	high chrome all. tool steel	DPM	HSS	stain- less	ground	polished	all polished
100 x 19 x 6,35	239B100265010	60°	0,1 - 0,15			X				X		
100 x 19 x 6,35	239B100265030	45°	0,1 - 0,15			X				X		
100 x 40 x 5,0	239B100020030	60°	0,15 - 0,2		X					X		
100 x 70 x 2,8	239B100497010	60°	0,15-0,2		X					X		

description			material				surface					
dimensions ØD x Ød x s	item no. 239B110 xxx xxx	cutting angle α	radius	cylinder	chrome alloyed tool steel	high chrome all. tool steel	DPM	HSS	stain- less	ground	polished	all polished
110 x 48 x 2,5	239B000469010	30°		0,2		X				X		

description			material				surface					
dimensions ØD x Ød x s	item no. 239B150 xxx xxx	cutting angle α	radius	cylinder	chrome alloyed tool steel	high chrome all. tool steel	DPM	HSS	stain- less	ground	polished	all polished
150 x 70 x 2,8	239B150021010	60°	0,15 - 0,2		X					X		
150 x 70 x 2,8	239B150213010	60°	0,15 - 0,2			X				X		

Other dimensions and materials on request.

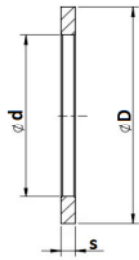

spacer			material						surface
dimensions	item no.	type	width	chrome alloyed	high chrome alloyed	DPM	HSS	stainless	ground
ØD x Ød x s	255S080 xxx xxx		tolerance	tool steel	tool steel				
80 x 60 x 1,0	255S080010060	ZR	+/- 0,005	X					X
80 x 60 x 2,0	255S080010090	ZR	+/- 0,005	X					X
80 x 60 x 3,0	255S080010110	ZR	+/- 0,005	X					X
80 x 60 x 4,0	255S080010130	ZR	+/- 0,005	X					X
80 x 60 x 5,0	255S080010140	ZR	+/- 0,005	X					X
80 x 60 x 10,0	255S080010230	ZR	+/- 0,005	X					X
80 x 60 x 20,0	255S080010320	ZR	+/- 0,005	X					X
80 x 60 x 50,0	255S080010420	ZR	+/- 0,005	X					X

spacer			material						surface
dimensions	item no.	type	width	chrome alloyed	high chrome alloyed	DPM	HSS	stainless	ground
ØD x Ød x s	255S110 xxx xxx		tolerance	tool steel	tool steel				
105 x 80 x 1,0	255S110006040	ZR	+/- 0,005	X					X
105 x 80 x 2,0	255S110006050	ZR	+/- 0,005	X					X
105 x 80 x 3,0	255S110006120	ZR	+/- 0,005	X					X
105 x 80 x 4,0	255S110006080	ZR	+/- 0,005	X					X
105 x 80 x 5,0	255S110006060	ZR	+/- 0,005	X					X
105 x 80 x 10,0	255S110006010	ZR	+/- 0,005	X					X
105 x 80 x 20,0	255S110006020	ZR	+/- 0,005	X					X

spacer			material						surface
dimensions	item no.	type	width	chrome alloyed	high chrome	DPM	HSS	stainless	ground
ØD x Ød x s	255S110 xxx xxx		tolerance	tool steel	tool steel				
105 x 90 x 1,0	255S110007070	UN	+/- 0,005	X					X
105 x 90 x 2,0	255S110007080	UN	+/- 0,005	X					X
105 x 90 x 3,0	255S110007250	UN	+/- 0,005	X					X
105 x 90 x 4,0	255S110007300	UN	+/- 0,005	X					X
105 x 90 x 5,0	255S110006060	UN	+/- 0,005	X					X
105 x 90 x 10,0	255S110007100	UN	+/- 0,005	X					X
105 x 90 x 20,0	255S110007110	UN	+/- 0,005	X					X
105 x 90 x 50,0	255S110007210	UN	+/- 0,005	X					X
105 x 90 x 100,0	255S110007610	UN	+/- 0,005	X					X

Other dimensions and materials on request .

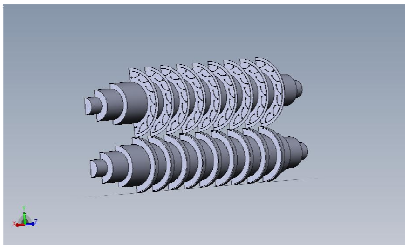

top knife type "Golden Slit"				material						surface
dimensions	item no.	cutting angle $\alpha$	width tolerance	chrome alloyed tool steel	high chrome alloyed tool steel	DPM	HSS	stainless	special coating "Long Life"	
75 x 30 x 0,5	238C080052010	30°	plus	X					X	
75 x 30 x 0,5	238C080052020	30°	minus	X					X	
105 x 60 x 1,0	238C110054010	30°	plus		X				X	
105 x 60 x 1,0	238C110054020	30°	minus		X				X	

bottom knife(narrow cut)			material						surface
dimensions	item no.	type	width tolerance	chrome alloyed tool steel	high chrome alloyed tool steel	DPM	HSS	stainless	ground
60 x 40 x 1,0	238D060049140		UN	plus		X			
60 x 40 x 1,0	238D060049010	UN	minus		X				X
60 x 40 x 1,2	238D060049020	UN	plus		X				X
60 x 40 x 1,2	238D060049150	UN	minus		X				X
60 x 40 x 1,25	238D060049270	UN	plus		X				X
60 x 40 x 1,25	238D060049280	UN	minus		X				X
60 x 40 x 1,4	238D060049750	UN	plus		X				X
60 x 40 x 1,4	238D060049760	UN	minus		X				X
60 x 40 x 1,5	238D060049030	UN	plus		X				X
60 x 40 x 1,5	238D060049160	UN	minus		X				X
60 x 40 x 2,0	238D060049040	UN	plus		X				X
60 x 40 x 2,0	238D060049170	UN	minus		X				X
60 x 40 x 2,5	238D060049050	UN	plus		X				X
60 x 40 x 2,5	238D060049180	UN	minus		X				X
60 x 40 x 3,0	238D060049060	UN	plus		X				X
60 x 40 x 3,0	238D060049190	UN	minus		X				X
60 x 40 x 3,5	238D060049090	UN	plus		X				X
60 x 40 x 3,5	238D060049220	UN	minus		X				X
60 x 40 x 3,6	238D060049290	UN	plus		X				X
60 x 40 x 3,6	238D060049300	UN	minus		X				X
60 x 40 x 4,0	238D060049080	UN	plus		X				X
60 x 40 x 4,0	238D060049210	UN	minus		X				X
60 x 40 x 5,0	238D060049110	UN	plus		X				X
60 x 40 x 5,0	238D060049240	UN	minus		X				X

bottom knife (narrow cut)			material						surface
dimensions	item no.	type	width tolerance	chrome alloyed tool steel	high chrome alloyed tool steel	DPM	HSS	stainless	ground
46 x 30 x 0,5	238D050044050		UN	plus		X			
46 x 30 x 0,5	238D050044210	UN	minus		X				X
46 x 30 x 1,0	238D050044020	UN	plus		X				X
46 x 30 x 1,0	238D050044140	UN	minus		X				X
46 x 30 x 1,2	238D050044270	UN	plus		X				X
46 x 30 x 1,2	238D050044300	UN	minus		X				X
46 x 30 x 1,4	238D050044030	UN	plus		X				X
46 x 30 x 1,4	238D050044200	UN	minus		X				X
46 x 30 x 1,5	238D050044060	UN	plus		X				X
46 x 30 x 1,5	238D050044090	UN	minus		X				X
46 x 30 x 2,0	238D050044040	UN	plus		X				X
46 x 30 x 2,0	238D050044150	UN	minus		X				X
46 x 30 x 2,5	238D050044100	UN	plus		X				X
46 x 30 x 2,5	238D050044110	UN	minus		X				X
46 x 30 x 3,0	238D050044070	UN	plus		X				X
46 x 30 x 3,0	238D050044160	UN	minus		X				X
46 x 30 x 4,0	238D050044170	UN	plus		X				X
46 x 30 x 4,0	238D050044180	UN	minus		X				X
46 x 30 x 5,0	238D050044250	UN	plus		X				X
46 x 30 x 5,0	238D050044260	UN	minus		X				X

Other dimensions and materials on request.

DIENES delivers also the applicable spacers in various dimensions and width tolerances.